

The New Dimension in Efficiency.

Jungheinrich PowerCube

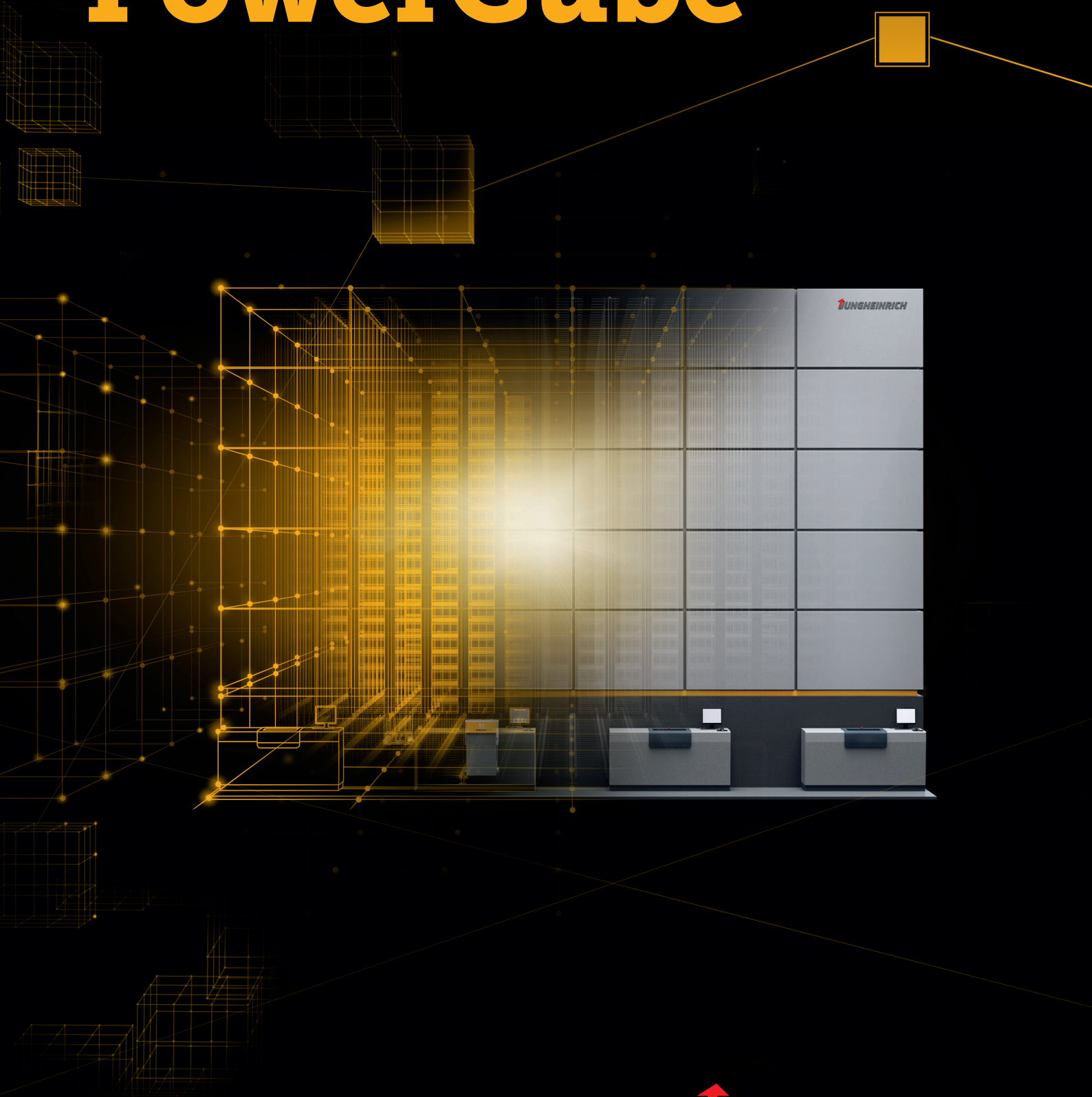

 **JUNGHEINRICH**

We are changing space and time.

Are you facing increasing time and cost pressure? Are you reaching your capacity limits? In this era of e-commerce and just-in-time delivery, innovative solutions are needed to increase profitability and competitiveness:

Announcing the automated, ultra-compact, flexible and scalable PowerCube from Jungheinrich. With its unique use of space, maximum flexibility, powerful performance and easy integration, the PowerCube sets new standards in the field of automated warehouse systems.

Within the PowerCube system, the individual containers are stacked vertically, stored, relocated and retrieved by automatic lithium-ion shuttles and taken to the workstations. This self-contained automation solution opens up a new dimension in efficiency for your warehouse in terms of organisation, space and time –

the new dimension in efficiency.

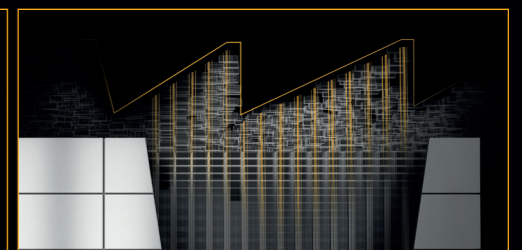
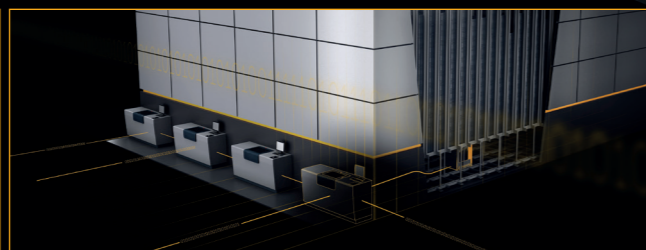
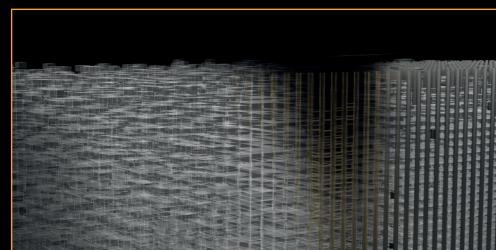

Unique use of space with extremely high storage density:

- Storage density is up to 4 times higher than a shelving system.
- Extremely high number of containers.
- A height of up to 12 metres makes the PowerCube the tallest compact storage system for containers in its class.
- Improved space and organisation in the warehouse.

Easy integration and connection to the IT environment:

- Short assembly and commissioning time.
- Suitable for normal industrial floors without the need for milling or sanding the floor.
- Integration into the IT environment is quick and easy.
- The PowerCube can be connected effortlessly, either to existing warehouse management software or an ERP system for transferring order data.
- As a general contractor with many years of automation and software expertise, Jungheinrich is able to offer everything from a single source. This sets the system apart from other comparable automated warehouse systems.

Powerful performance with high throughput and no downtime:

- Shuttles charge their lithium-ion batteries during operation, this means they have no downtime and can be efficiently operated 24/7.
- Each shuttle can pick up 2 containers at a time, further improving the throughput rate.
- Each container has a payload of up to 50 kg – this is unprecedented for a compact storage system for containers.
- In addition, PowerCube system containers are compatible with external materials handling equipment and can be used outside of the compact warehouse system.

Maximum flexibility and scalability:

- The number of shuttles and containers is scalable, which means that throughput can be flexibly increased.
- The PowerCube can also be adapted to different roof shapes – an advantage over conventional storage systems.
- It is therefore ideal for existing buildings and suitable for relocation.
- The PowerCube can be used as a stand-alone solution, an addition to wide-aisle warehouses or the key component of a complex automated system.

Efficiency in motion.
Automation with Jungheinrich.

Contact us!
Find out more at www.jungheinrich.xx/PowerCube

ISO 9001 Zertifiziert sind die deutschen
ISO 14001 Produktionswerke in Norderstedt,
Moosburg und Landsberg.

 Jungheinrich-Flurförderzeuge
entsprechen den europäischen
Sicherheitsanforderungen.

Jungheinrich
Vertrieb Deutschland AG & Co. KG

Friedrich-Ebert-Damm 129
22047 Hamburg
Telefon 0800 222 585858*

*Deutschlandweit kostenfrei

info@jungheinrich.de
www.jungheinrich.de

 **JUNGHEINRICH**